



## DESIGN FEATURES

- Compliant with global standards.
- Certified to EN regulations.
- Weasler's guard systems are lab tested in harsh conditions including exposure to ultraviolet light and ozone under accelerated aging cycles to insure long life.

## Easy Lock Guard



### PATENTED

*The Easy Lock System provides for a fast, efficient guard assembly and removal process. Lubrication access holes are incorporated which makes the lubrication of the joint through the guard easier.*

## PERFORMANCE BENEFITS

- EASY LOCK CONSTRUCTION ALLOWS QUICK AND EASY ASSEMBLY WITHOUT TOOLS.
- A SIMPLE TOOL SUCH AS A KEY, COIN OR SCREWDRIVER CAN BE USED TO REMOVE THE GUARD.
- THE EASY LOCK CLIP INCORPORATES A ZERK FOR EASE OF LUBRICATION.
- EASIER LUBRICATION OF THE DRIVE SHAFT THROUGH GREASE ACCESS HOLES SO THE GUARD DOES NOT NEED TO BE REMOVED FOR LUBRICATION.
- BLACK COLOR HAS LONGEST DURABILITY AGAINST ULTRAVIOLET LIGHT AND OZONE.



## MANUFACTURING LOCATIONS

**WEASLER ENGINEERING, INC.**  
 P.O. Box 558  
 West Bend, Wisconsin, 53095 USA  
 Tel: +1 (262) 338 2161  
 Email: [omealsales@weasler.com](mailto:omealsales@weasler.com)

**WEASLER ENGINEERING TURKEY**  
**Power Packer Turkey**  
 Akhisar Organize Sanayii Bolgesi 5.  
 Cadde No: 33  
 Akhisar Manisa 45230  
 Turkey  
 Tel: +31 (0)24 64 89 100  
 Email: [sales@weasler.nl](mailto:sales@weasler.nl)

**WEASLER ENGINEERING KFT**  
 P.O. Box 262, H6001,  
 Kecskemet, Hungary  
 Tel: +31 (0)24 64 89 100  
 Email: [sales@weasler.nl](mailto:sales@weasler.nl)

**WEASLER ENGINEERING BRASIL**  
**Turotest Medidores Ltda.**  
 Ave Luiz Merenda, 489 - Campanário,  
 Diadema - SP, 09931-390  
 Brasil  
 Tel: +55 (11) 40927204  
 Email: [info.sa@weasler.com](mailto:info.sa@weasler.com)

## Easy Lock Guard

### TOOLS REQUIRED:

- Screwdriver
- Multipurpose grease

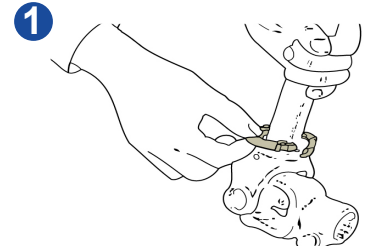
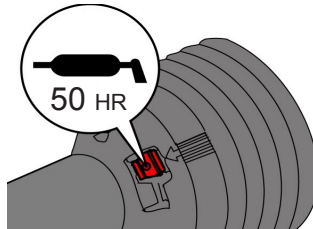

Clean and grease bushing groove before the bushing is placed in the groove. Grease any remaining bushings in guard.

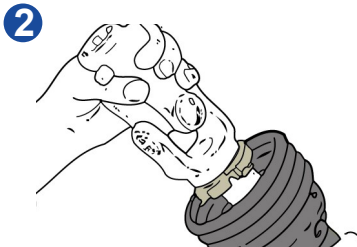

Slide guard half over drive shaft and insert bushing tabs into the opening in the guard.

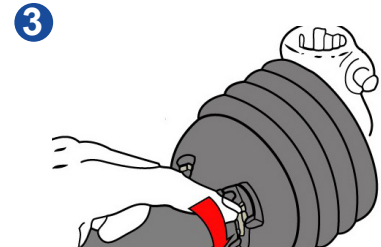

Turn the bushing until it engages into the guard.

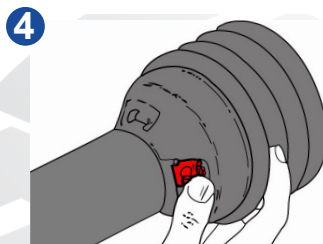

Push Easy Lock clip into position. The bushing and guard are now secured.

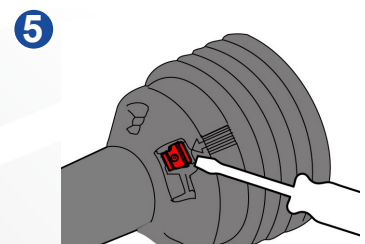

**TO REMOVE GUARD** - Use screwdriver to release Easy Lock clip. Turn the bushing to disengage from the guard and remove guard.



### IMPORTANT

Check that **GUARD MISSING** decal on steel tube under inner guard and **ROTATING DRIVE SHAFT** decal on outer guard are firmly affixed, undamaged and readable. **IF NOT REPLACE.**